

Hole "A" .160" ϕ thru
 Hole "B" are #4-40 threaded 4of
 Hole "C" are .266" ϕ thru, 3of.

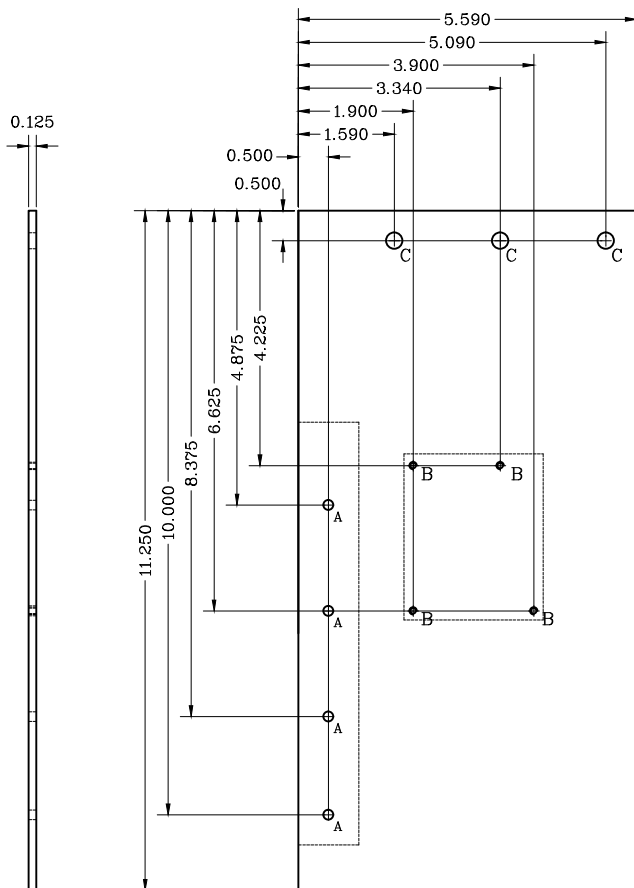

TLC MAIN PANEL, 5 REQUIRED

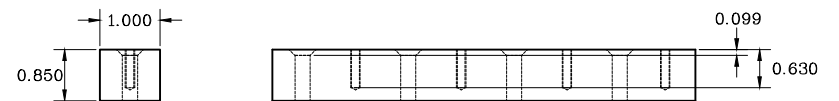
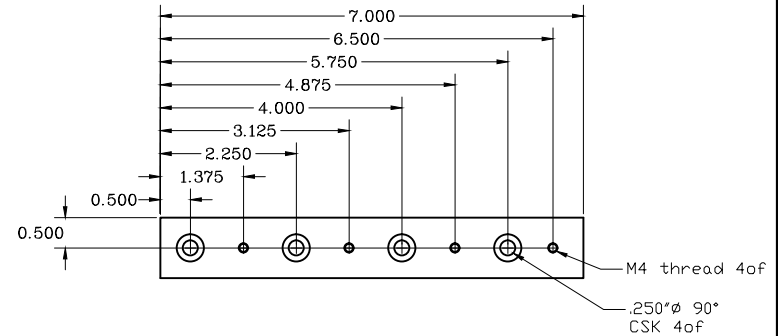

TLC PANEL MOUNTING BRACKET, 5 REQUIRED

ALMA-05.11.34.11-0005-A-DWG			NATIONAL RADIO ASTRONOMY OBSERVATORY		
Prepared by:			CHARLOTTESVILLE, VA. 22903		
Names and Signatures:		Organization	Date	TITLE	
		NRAO	10/2/14	LEVEL CONVERTER PCB PANEL	
Approved by:		Organization	Date	PROJECT	
				PIC Phasing project, account#2314	
Released by:		Organization	Date	DESIGN	FILE
				L Platt	5/15/14
Names and Signatures:		Organization	Date	DRAWN	FILE
				L Platt	5/15/14
				MATERIAL	Aluminum
				FINISH	Yellow Chromate
				SHEET	1 of 1
				Dim in Inches with Metric threads	
				SCALE	SIZE
				DWG.	REV