

8

7

6

5

4

3

2

1

REV	DATE	ICO NO.	APPRVD BY	DESCRIPTION

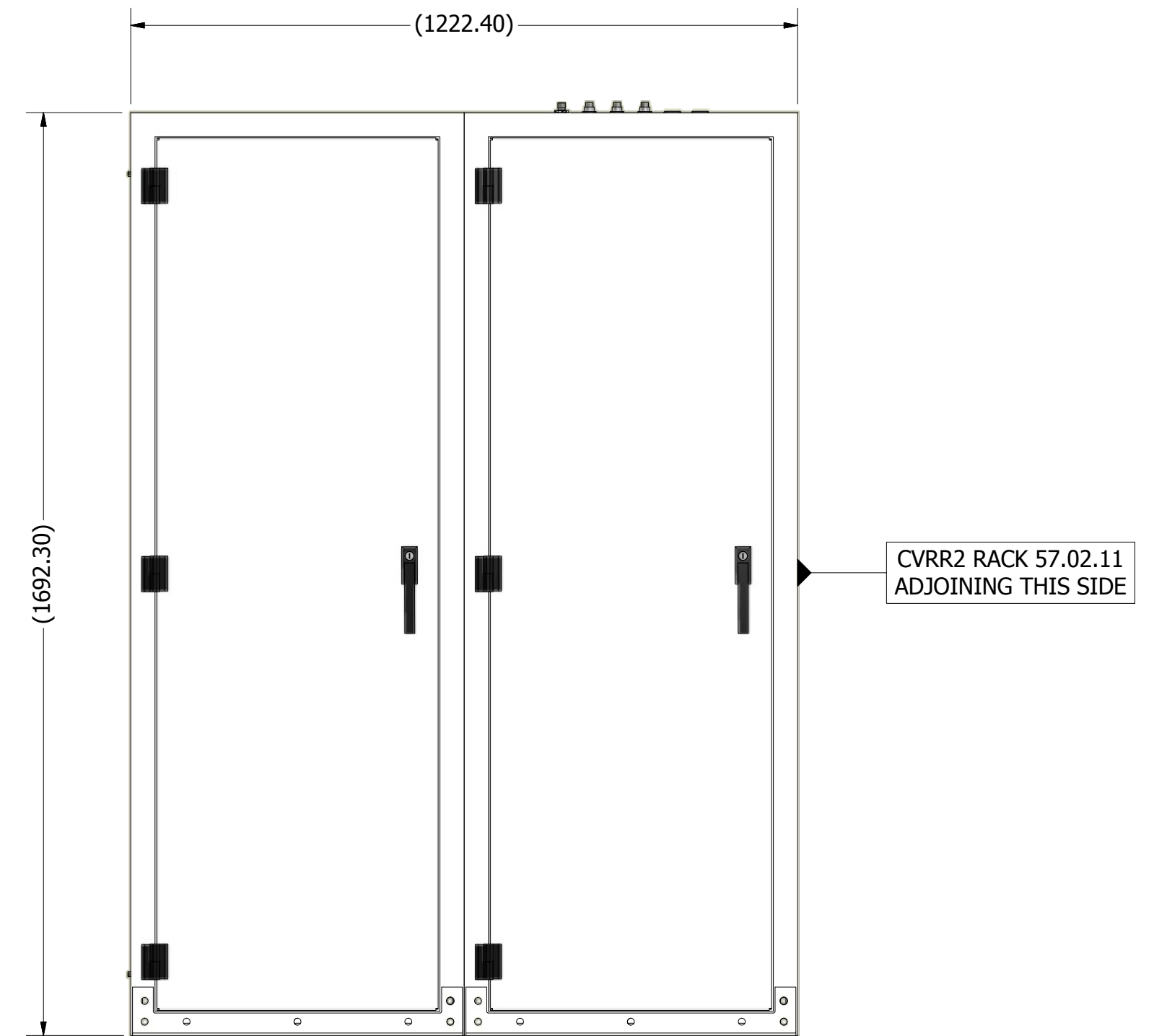
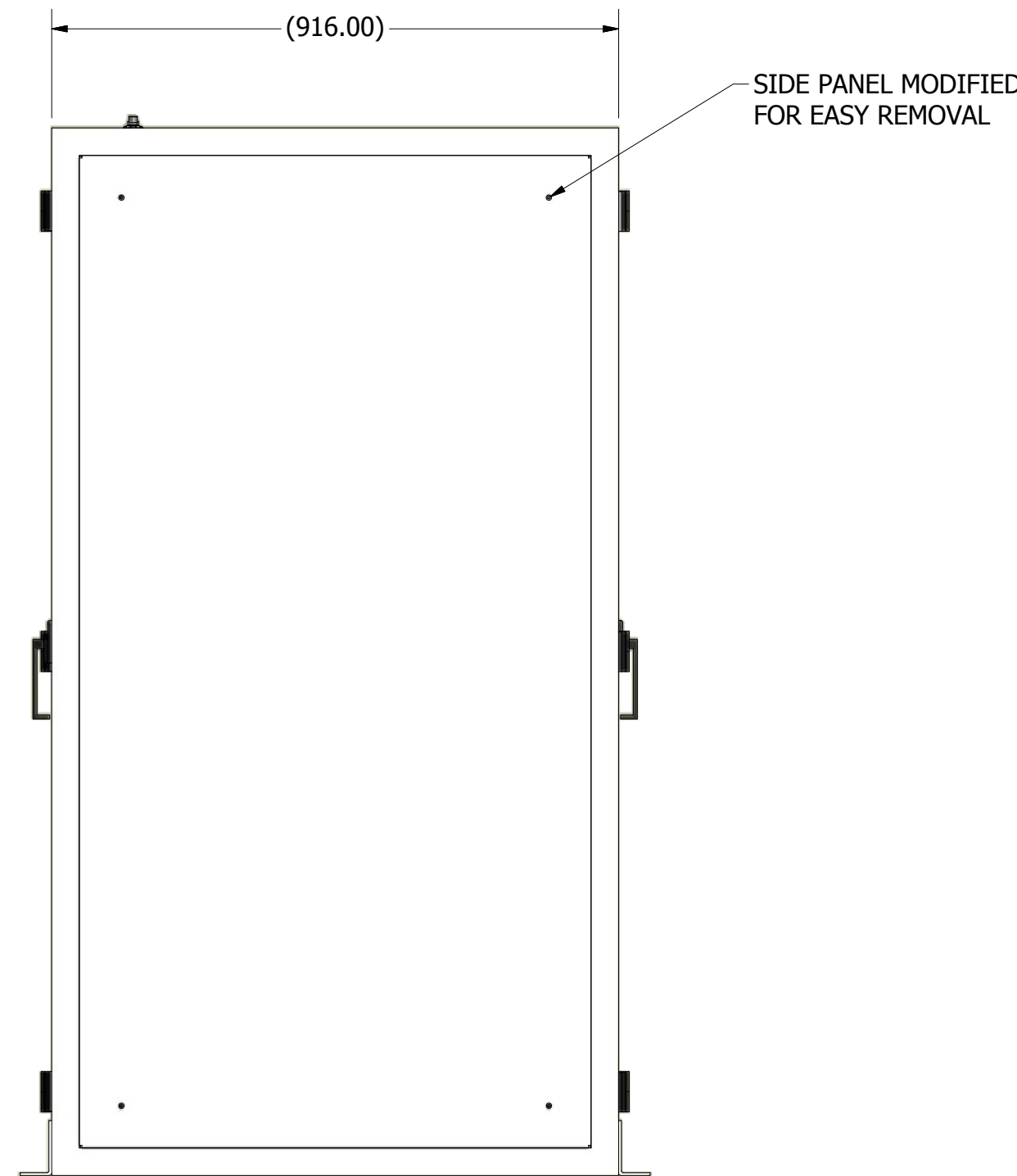
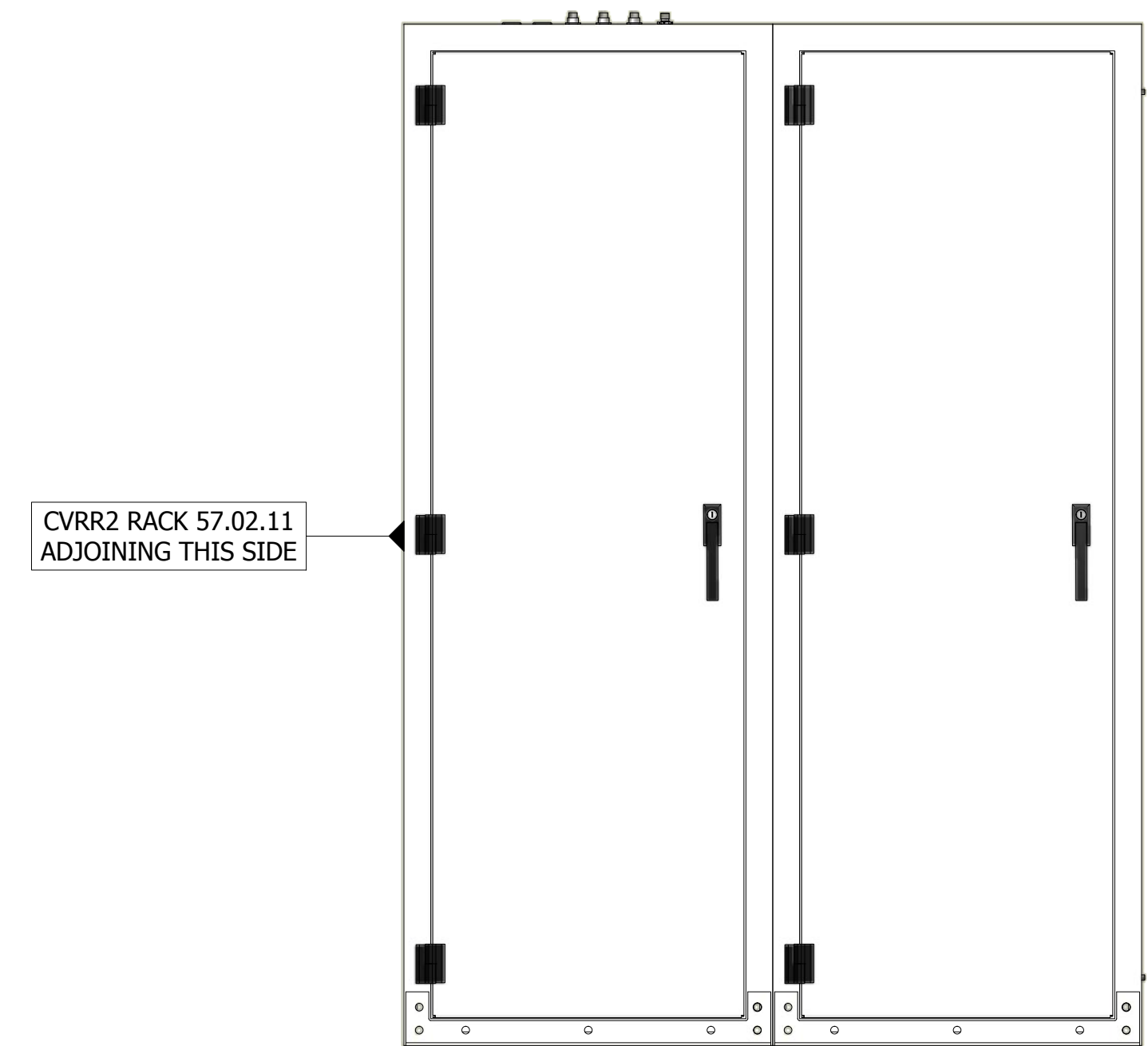
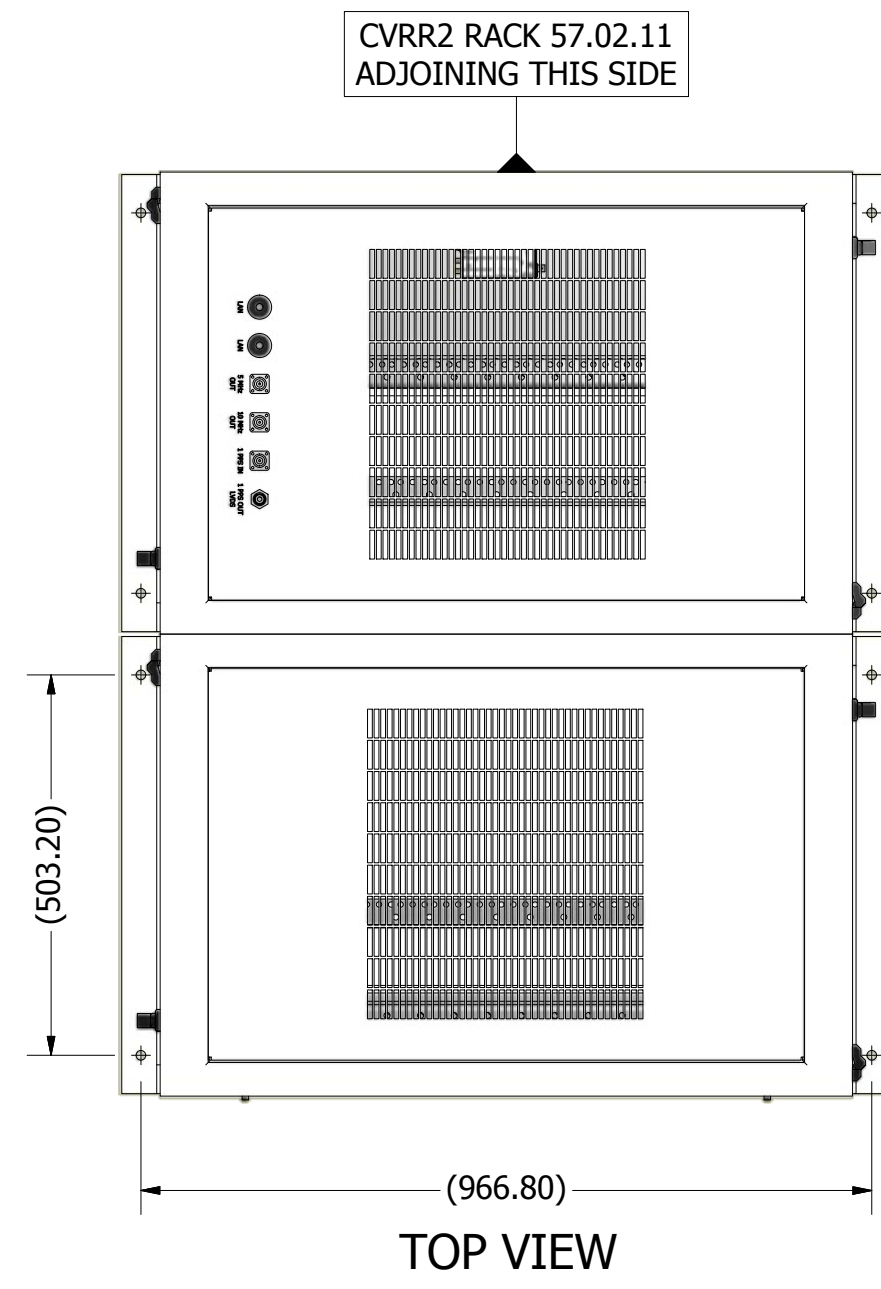

NOTES:  
1. RACK EXTERIORS SHOWN.  
2. DIMENSIONS ARE FOR REFERENCE ONLY.



ATACAMA LARGE MILLIMETER ARRAY (ALMA) PROJECT  
NATIONAL RADIO ASTRONOMY OBSERVATORY  
1180 BOXWOOD ESTATES ROAD  
CHARLOTTESVILLE, VIRGINIA 22903

TITLE  
MASER RACK LAYOUT

UNLESS OTHERWISE SPECIFIED DIMENSIONS ARE IN MILLIMETERS		DESIGN		RECOMMENDED BY	
TOLERANCES		DRAWN	2013-07-25	ENGINEER	
ANGLES: ± .5°		CHECKED		APPROVED	
3 PLACE DECIMALS (.xxx) ± .127		NAME		DATE	SIGNATURE
2 PLACE DECIMALS (.xx) ± .25		SCALE		DATE	DATE
1 PLACE DECIMALS (.x) ± .4		SIZE			
MATERIAL: N/A		SCALE	SIZE	SHEET	DRAWING NO.
FINISH: N/A		NTS	D	1 OF 3	MASER-RACK-LAYOUT

D

D

C

C

B

B

A

A

8

7

6

5

4

3

2

1

8

7

6

5

4

3

2

1

REV	DATE	ICO NO.	APPRVD BY	DESCRIPTION

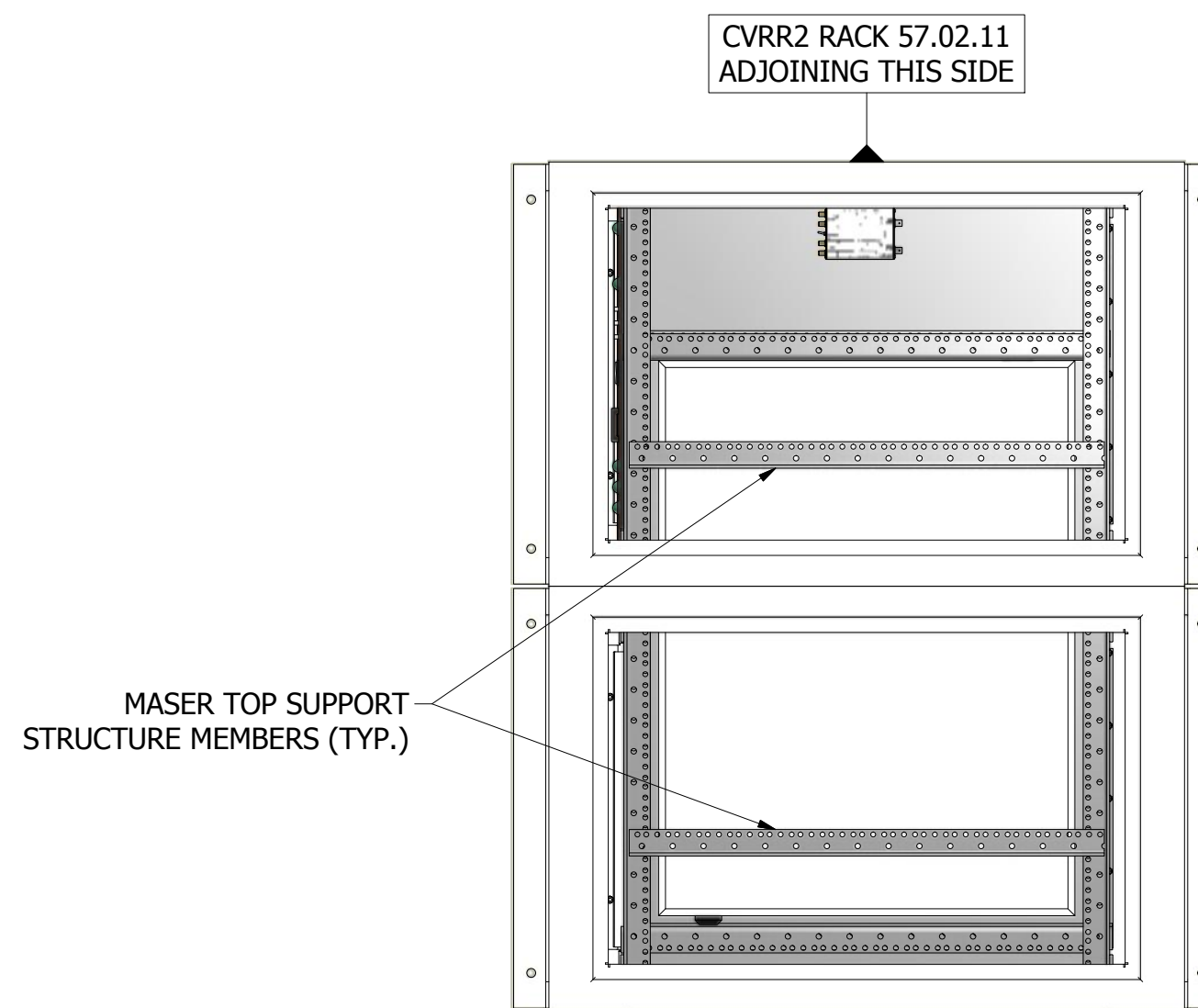

TOP VIEW

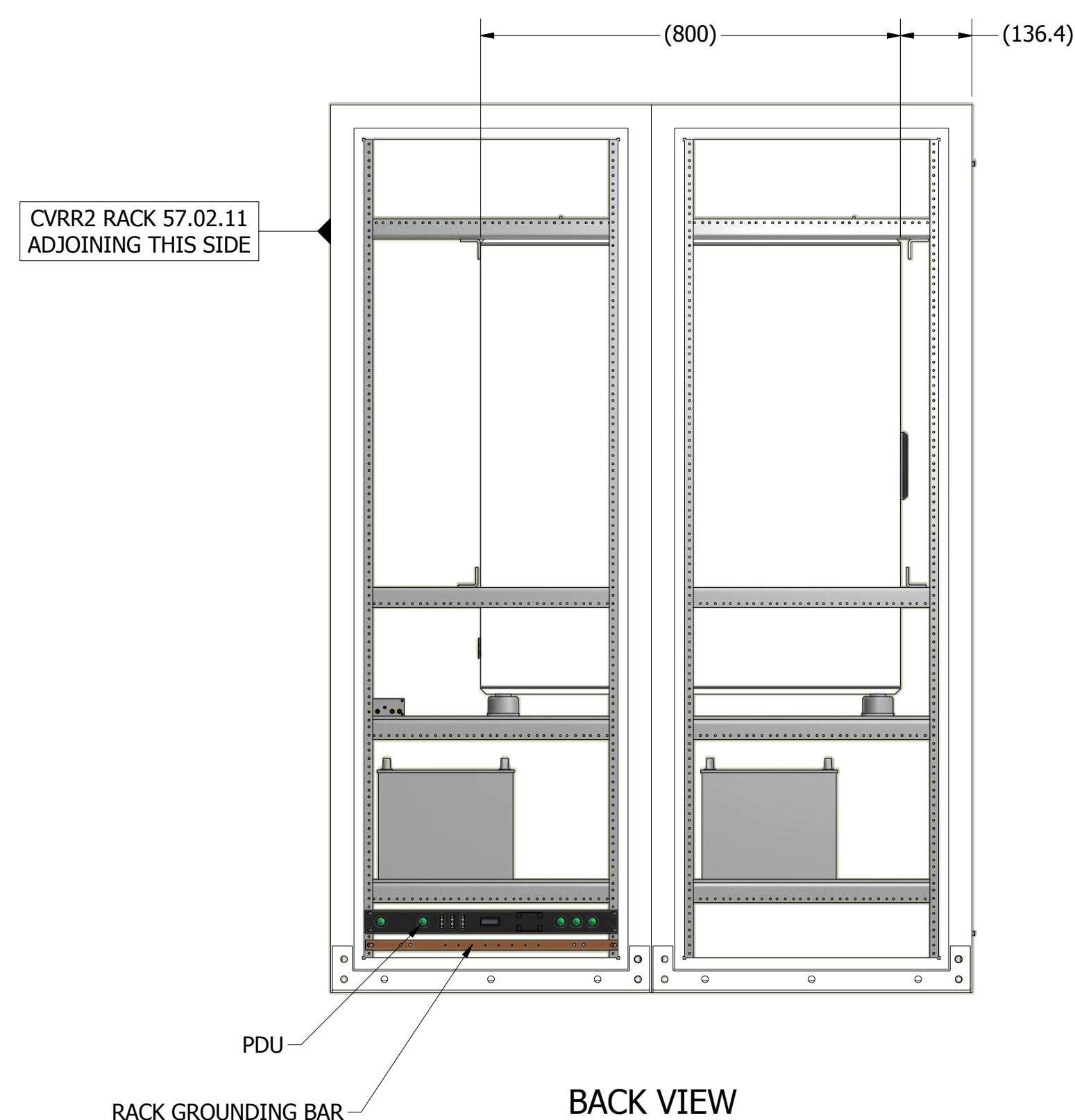

BACK VIEW

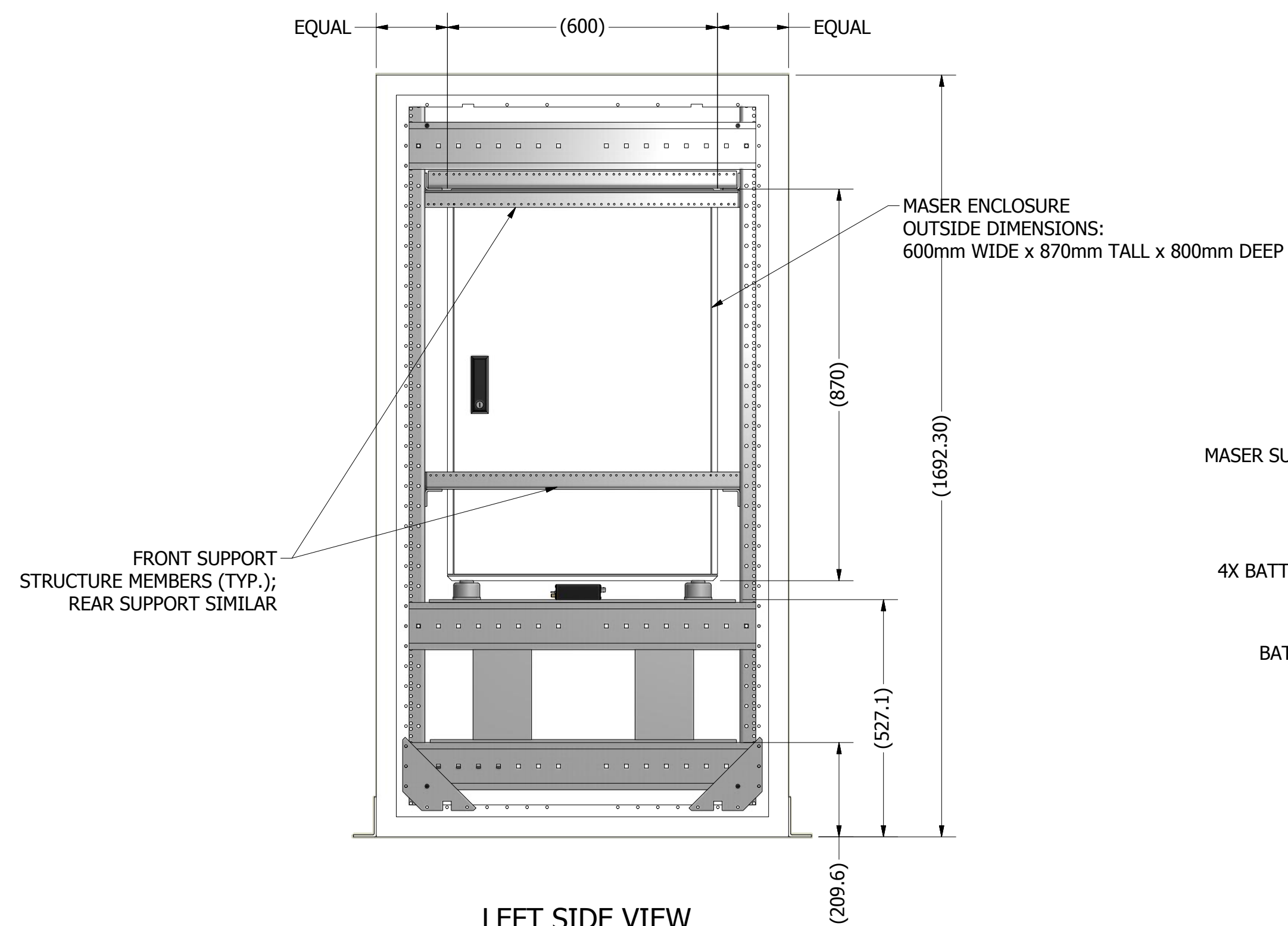

LEFT SIDE VIEW (MASER FRONT)

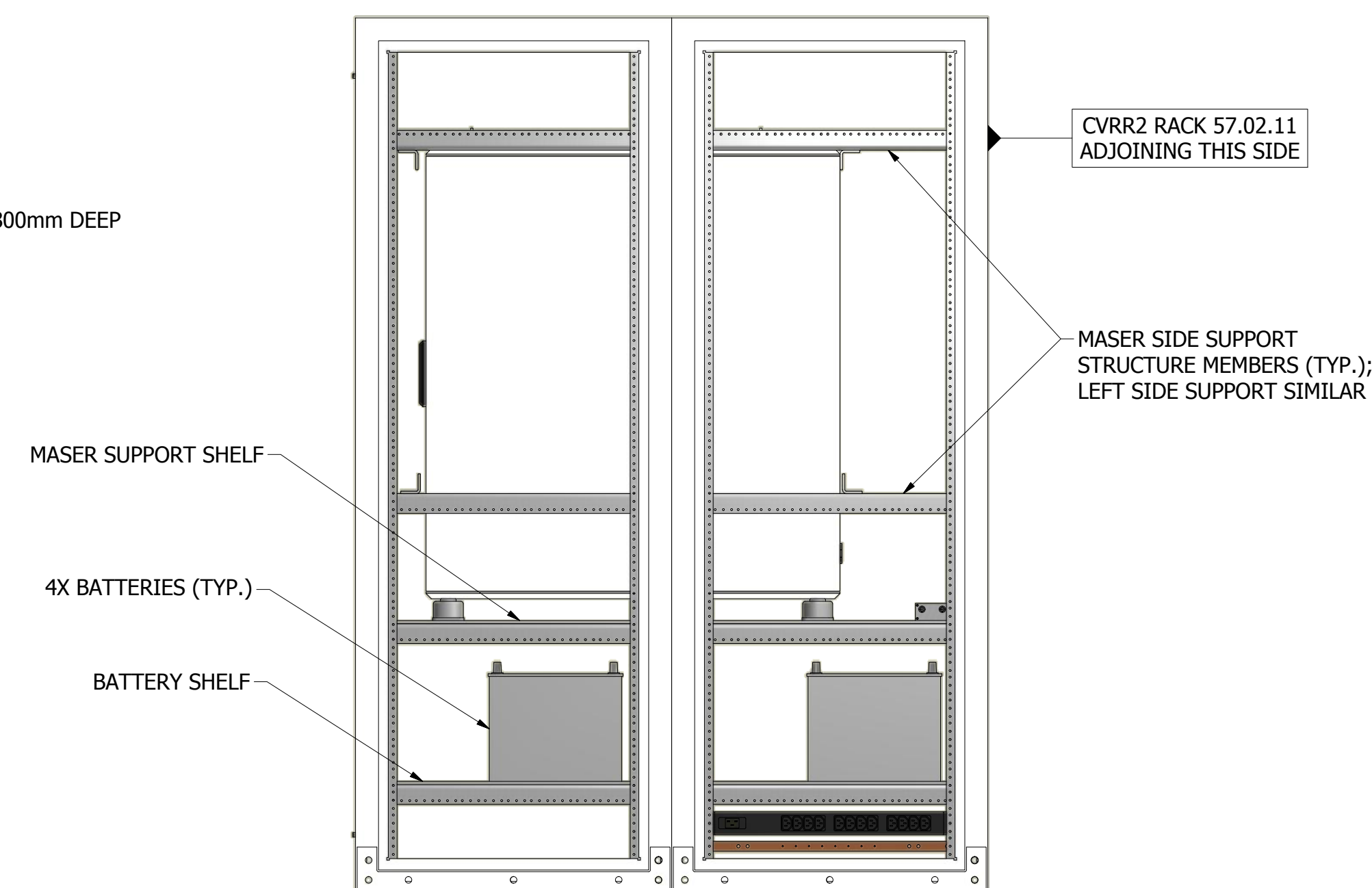

FRONT VIEW

- NOTES:  
 1. RACK EXTERIOR PANELS SHOWN REMOVED.  
 2. DIMENSIONS ARE FOR REFERENCE ONLY.  
 3. MASER IS SECURED IN ALL THREE (3) AXES BY THE SUPPORT STRUCTURE SHOWN.



ATACAMA LARGE MILLIMETER ARRAY (ALMA) PROJECT  
 NATIONAL RADIO ASTRONOMY OBSERVATORY  
 1180 BOXWOOD ESTATES ROAD  
 CHARLOTTESVILLE, VIRGINIA 22903

TITLE  
**MASER RACK LAYOUT**

UNLESS OTHERWISE SPECIFIED DIMENSIONS ARE IN MILLIMETERS		DESIGN		RECOMMENDED BY	
TOLERANCES		DRAWN	2013-07-25	ENGINEER	
ANGLES: ± .5°		CHECKED		APPROVED	
3 PLACE DECIMALS (.xxx) ± .127		SCALE	NAME	DATE	SIGNATURE
2 PLACE DECIMALS (.xx) ± .25		SIZE			
1 PLACE DECIMALS (.x) ± .4		SHEET	DRAWING NO.		DATE
MATERIAL: N/A	NTS	D	MASER-RACK-LAYOUT		REV. A
FINISH: N/A		2 OF 3			

8

7

6

5

4

3

2

1

8

7

6

5

4

3

2

1

REV	DATE	ICO NO.	APPRVD BY	DESCRIPTION

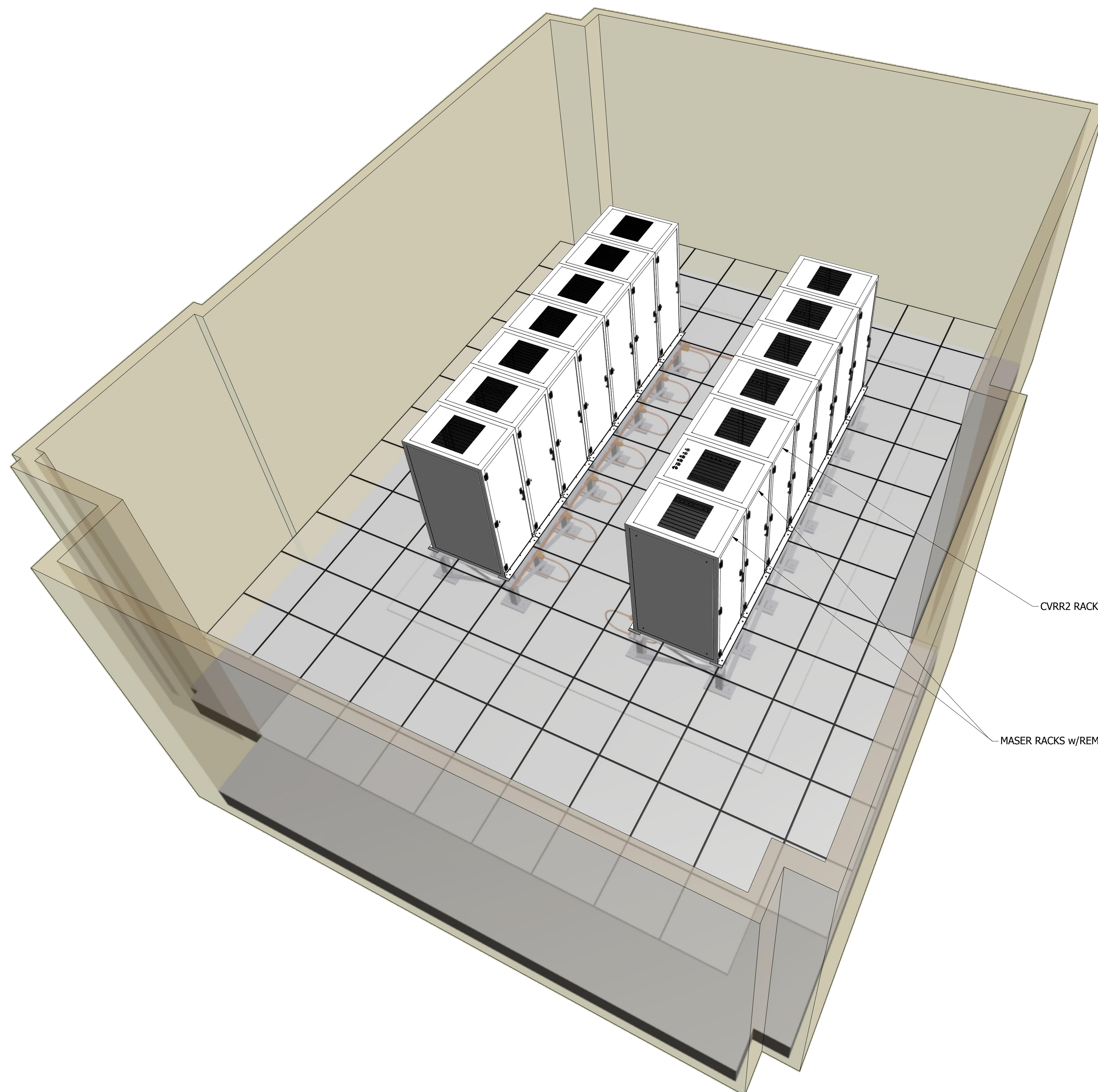

CVRR2 RACK 57.02.11

MASER RACKS w/REMOVABLE SIDE PANEL

LO ROOM 127

- NOTES:
1. LO ROOM AND RACK LOCATIONS SHOWN FOR REFERENCE ONLY.
  2. FLOOR TILES TRANSPARENT TO SHOW SEISMIC STRUCTURE AND GROUNDING NETWORK.
  3. RACK CABLING AND OTHER ROOM FEATURES NOT SHOWN FOR DRAWING CLARITY.



ATACAMA LARGE MILLIMETER ARRAY (ALMA) PROJECT  
 NATIONAL RADIO ASTRONOMY OBSERVATORY  
 1180 BOXWOOD ESTATES ROAD  
 CHARLOTTESVILLE, VIRGINIA 22903

TITLE  
**MASER RACK LAYOUT**

UNLESS OTHERWISE SPECIFIED  
 DIMENSIONS ARE IN MILLIMETERS

TOLERANCES  
 ANGLES: ± .5°  
 3 PLACE DECIMALS (.xxx) ± .127  
 2 PLACE DECIMALS (.xx) ± .25  
 1 PLACE DECIMALS (.x) ± .4

MATERIAL: N/A  
 FINISH: N/A

DESIGN			RECOMMENDED BY	
DRAWN		2013-07-25	ENGINEER	
CHECKED			APPROVED	
SCALE	SIZE	SHEET	SIGNATURE	
NTS	D	3 OF 3	DRAWING NO.	
			MASER-RACK-LAYOUT	
			DATE	REV.
				A

8

7

6

5

4

3

2

1